

## SolarInvert Energy Solutions

# What battery inverter should I use for 800w appliances



## Overview

---

To effectively power an 800W microwave, you should consider an inverter rated significantly higher than the microwave's wattage. A good rule of thumb is to select an inverter that provides at least 1.5 to 2 times the wattage of the microwave. Can a 800 watt inverter run a 12V battery?

With the help of an 800 watt inverter, light gadgets, and electrical tools can function on AC power from a 12V or 24V battery. There are some restrictions on what can be powered by this inverter, therefore it is crucial to know which devices can be used to avoid harming the inverter. So, what appliances can a 800 watt inverter run?

.

How many watts can an 800W inverter run?

Most inverters also have a surge capacity twice its running load limit, so an 800W inverter usually has a 1600W surge watt limit. The math is simple. As long as the total watts used by the appliances is 800 watts or less, the inverter can run it. Here is the average power consumption of some popular appliances that an 800W inverter can handle.

Can an 800 watt inverter run a 320 watt load?

An 800 watt inverter powered by a 12V 100ah battery can run a 320 watt load for approximately 3.75 hours. The steps above can be used for any battery capacity or voltage. Solar batteries are available in different sizes and voltages, but the calculations remain the same. Take the same 320 watt load but this time you have a 12V 220ah battery.

How much battery do I need to run a 3000-watt inverter?

You would need around 24v 150Ah Lithium or 24v 300Ah Lead-acid Battery to run a 3000-watt inverter for 1 hour at its full capacity Here's a battery size chart for any size inverter with 1 hour of load runtime Note! The input voltage of the inverter should match the battery voltage.

What does an 800W inverter do?

For more details, [click here](#). An inverter allows you to run appliances, tools and other electronic devices from solar panels. It converts direct current from the panels into alternating current (AC) so appliances can use it. So how many of these devices can you power on an 800W inverter?

.

How many amps does a 12V 800 watt inverter draw?

If you load 800 watts onto a 12V 800 watt inverter, it will draw 66.6 amps. Divide the total wattage by the voltage and you get the amps drawn. Only the watts consumed should be used, not the inverter capacity. If you have a 600W inverter but only carrying 350 watts, use 350 in the calculation.

## What battery inverter should I use for 800w appliances

---



### What will an 800 Watt Inverter Run?

To find out how many batteries do you need for a 800 watt inverter, you have to know the hours for which your inverter runs and multiply ...

[Get Price](#)

## The Only Inverter Size Chart You'll Ever Need

We have created a comprehensive inverter size chart to help you select the correct inverter to power your appliances.



[Get Price](#)



### What appliances can I use on a 1000W power inverter?

3. The time a 12-volt battery runs a 1000-watt power inverter depends on battery capacity, inverter efficiency, depth of discharge, battery ...

[Get Price](#)

## Can a 800W Inverter Run a Battery Charger?

Yes, an 800W inverter can run a battery charger--but only if the charger's power demands stay within the inverter's limits. Many assume any inverter can handle a charger, but ...

[Get Price](#)



### "Low Battery Charge" HELP

The battery monitoring system on the car uses a sensor (shunt) connected to the battery negative terminal to monitor current charged or drawn from the battery. This is ...

[Get Price](#)

### Secondary Battery

My main battery just died, had it replaced with same, and car kept giving me Battery charging, so no stop start. When stop/start worked, it was for about 10 sec, and car ...

[Get Price](#)



### Household Battery Recycling

Household battery recycling locations  
Lead-acid batteries, or "automotive type batteries," are banned from disposal. Consumers may bring lead-acid batteries to any Wisconsin retailer that ...

[Get Price](#)

---

### **Can I Attach My Small Inverter Directly to the Battery?**

Yes, you can attach a small inverter directly to a battery, but doing it safely requires understanding voltage compatibility, wire sizing, and overload risks. Many DIYers assume it's ...

[Get Price](#)

---

### **What Can an 800W Inverter Run?**

As long as the total watts used by the appliances is 800 watts or less, the inverter can run it. Here is the average power consumption of some popular appliances that an 800W inverter can handle.

[Get Price](#)

---

### **What Appliances Can 1500 Watt Inverter Run? (Examples)**

An inverter is the core part of any solar power system. For this, you have to choose it wisely and determine if it will fulfill your requirements. As a general

rule, power usage from ...

[Get Price](#)



### **12v or 24v 800w system which is better?**

Besides cost, which is better 24v or 12v for my new 800w system? Im gonna build one of these. I don't need 12v dc and I have never used or build a 24v setup before.

[Get Price](#)

### **? Appliances You Can and Cannot Use with an Inverter - A Guide**

At A& E Dunamis, we manufacture high-efficiency inverters designed to support a wide range of household and office appliances. In this guide, we'll help you understand which ...

[Get Price](#)



### **Everything you need to know about inverters**

How much power will my inverter draw? The power required to run an inverter is approximately 8-10% more than the power load of the ...

[Get Price](#)

## What Can a 1000 Watt Inverter Run? (Fridge, ...

A 1000-watt inverter is a device that takes direct current (DC) energy -- typically from a battery or solar panel -- and transforms it into ...

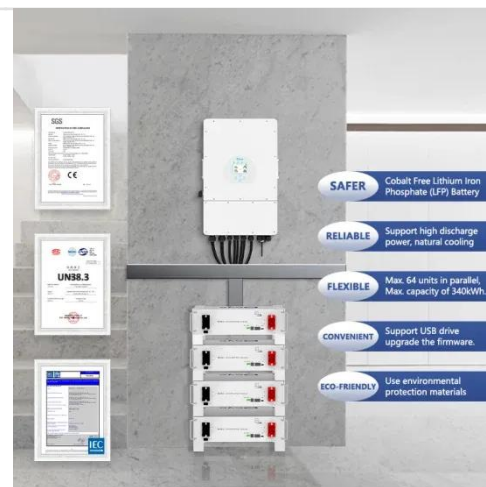
[Get Price](#)

## Battery Drain Issues

I had a new battery installed in November (from Halfords) and decided to bring to Halfords garage and they confirm the battery and alternator were OK. When Volvo re-opened, ...

[Get Price](#)

## EFB or AGM Upgrade

Hi, Main battery needs changed, currently has the OEM EFB battery. Thinking of upgrading to an AGM Battery, has anyone done this and had any issues??



[Get Price](#)

### Battery Question

I have 2 questions; I have 2 12v/220Amh lead acid batteries, 800w in panels, charge controller, and 1500w inverter. Question 1. Is it possible to run 120v appliances off of ...

[Get Price](#)

### an a 800W Inverter Run a Battery Charger?

Before connecting an 800W inverter to a battery charger, you must analyze three critical factors: continuous wattage, surge capacity, and efficiency losses. Many users assume ...

[Get Price](#)

### Inverter Selection Calculator

The Inverter Selection Calculator helps you determine the ideal inverter size (kVA) and battery capacity (Ah) based on your power consumption and required backup time.

[Get Price](#)

## Calculate Battery Size For Any Size Inverter (Using Our Calculator)

We have created a comprehensive inverter size chart to help you select the correct inverter to power your appliances.

[Get Price](#)

## What Can an 800W Inverter Run?

As long as the total watts used by the appliances is 800 watts or less, the inverter can run it. Here is the average power consumption of some popular ...

[Get Price](#)

## My setup, 800 watts of solar, 40 amp MPPT charge ...

My setup, 800 watts of solar, 40 amp MPPT charge controller, Two 12.8v 100Ah LiFePo4 batteries connected in series for 25.6v, 600-watt pure sinewave

...

[Get Price](#)

### **I Tested the Power and Reliability of an 800 Watt Power Inverter**

In this article, we will explore the world of power inverters and specifically focus on the powerful 800 watt model. From its uses and benefits to tips for choosing the right one for ...

[Get Price](#)

### **How Many Batteries Do I Need For a 1000 Watt Inverter**

Divide the battery's available energy (Wh) by the energy consumption of the load (W) to find the runtime in hours. I hope this guide has ...

[Get Price](#)

### **I Tested the Power and Reliability of an 800 Watt ...**

In this article, we will explore the world of power inverters and specifically focus on the powerful 800 watt model. From its uses and benefits ...

[Get Price](#)

## How to Choose the Right Inverter Size for Your Home

In this guide, we'll walk you through calculating your home's power needs, understanding battery requirements, and why Leaptrend inverters are a top choice for ...

[Get Price](#)

## Finding the Right Inverter Size for Your 800W Microwave

To effectively power an 800W microwave, you should consider an inverter rated significantly higher than the microwave's wattage. A good rule of thumb is to select an inverter that ...

[Get Price](#)

## Unlocking the Power of 800W: What Can You Run Off an 800W Inverter?

An inverter converts DC power from batteries or solar panels into AC power, allowing you to run various appliances and devices. But have you ever

wondered what you ...

[Get Price](#)



### Calculate Battery Size For Any Size Inverter (Using Our Calculator)

You would need around 24v 150Ah Lithium or 24v 300Ah Lead-acid Battery to run a 3000-watt inverter for 1 hour at its full capacity. Here's a battery size chart for any size inverter ...

[Get Price](#)

### Low battery charge Power save mode

My 2011 s60 Volvo has shown Low Battery since I purchased the car in August 2023. I have a new battery in the car since September,2024. The car starts up okay at this ...

[Get Price](#)



### Battery issues

I've had both batteries replaced (with the correct models), done a 100 mile trip, overnight smart battery charge, charging voltage is fine, system messages cleared but I am ...

[Get Price](#)

---

## Battery Recycling for Businesses

Battery Recycling for Businesses Use the chart below to determine how to handle used batteries generated by your business. Batteries that are considered hazardous must be recycled or ...

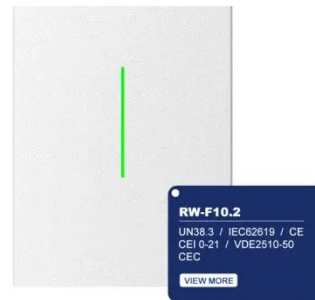
[Get Price](#)

---

## Contact Us

For catalog requests, pricing, or partnerships, please visit:  
<https://www.barkingbubbles.co.za>